

NYLON ONE PIECE SELF DRILLING ANCHOR

Fortress Pro-Pak Nylon Plasterboard Screws are a one piece self drilling anchor designed for use in hollow plasterboard for light duty loads.

TECHNICAL DATA:

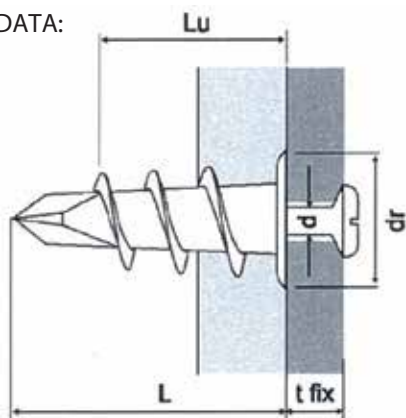

tfix = fixture thickness

d = screw diameter

L = anchor length

dr = washer diameter

Lv = screw length

Lu = minimum thread engagement

(Lv = Lu + tfix)

Product Size Ø x L	d (mm)		dr (mm)	Lu (mm)	Lv (mm)
	(mm)	(mm)			
Ø6.5 x 30	3.5	4.5	30	60	35

BASE MATERIAL – PRO-PAK Metal Plaster Board Screw can be applied to the following base material

 Plasterboard

INSTALLATION GUIDE – Position anchor in the desired area, press firmly and wind until secure. Then apply self tapping screw through the centre of the anchor

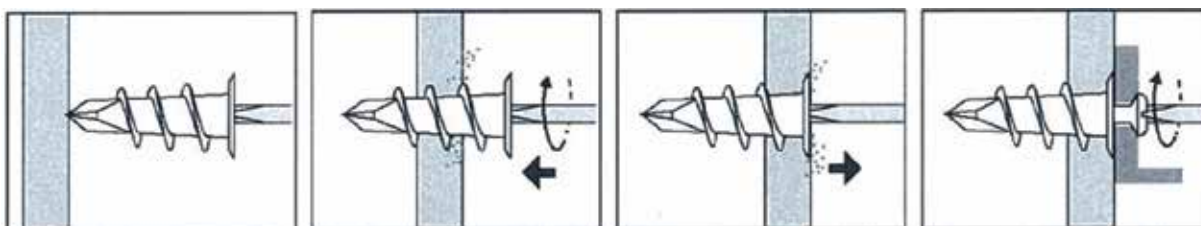

RECOMMENDED LOADS

Plasterboard (13mm)	Tensile	kN	0.05
	Shear	kN	0.10
Edge Distance		mm	50
Anchor Spacing		mm	50